

STATE OF ALABAMA

ALABAMA HISTORICAL COMMISSION
 725 MONROE STREET
 MONTGOMERY, ALABAMA 36130
 PHONE: 832-6621



ALABAMA INVENTORY AND WORKSHEET FOR LANDMARKS

COUNTY Baldwin

PRESENT NAME Old English Place HISTORIC NAME Atkinson-Till House

LOCATION (Street and number) Near Tensaw, Alabama

TOWN (Give directions if rural) East of Highway 59 approximately 12 miles north of I-65.

PRESENT USE Hunting lodge HISTORIC USE Private residence

OWNERSHIP: Public () Private (x) Public acquisition being considered ()

OWNER'S NAME Dr. J. R. Till (Epile) Mrs.

MAILING ADDRESS P. O. Box 1422
Canyon Lake, Texas

CONDITION: Excellent () Good () Fair (x) Ruins ()

INTEGRITY: Original Site (x) Moved () When? _____

From where? _____ Give details in significance.

THREATS: No () Yes (x) By What? Neglect

RESTORATION WORK: Being considered () Underway () Completed () Not planned (x)

SURROUNDING ENVIRONMENT: Open land (x) Woodland (x) Scattered buildings ()
 High building density () Commercial () Industrial ()
 Residential () Rural (x)

If there are numerous buildings in the area, could this structure be part of a Historic District?

SIGNIFICANCE: Why is this important (x) associated with events, persons, or movements
 Local (x) State () National ()
 () a good example of a type or style of structure
 () other

Explain: (Expand on the significance of the building. If architecturally significant, give details being very specific. Additional data on what aspects of the community's development the building represents, or a specific event, trend or person related to the building's importance.) Thomas Atkinson built the house using slave labor shortly after marrying Sarah English, the daughter of an influential landowner in the area. A wealthy planter in his own right, Atkinson turned his home into the center of local society. According to local custom during the War Between the States Federal troops camped around the plantation while Atkinson's sons were off defending the sanctity of the South's soil.

Date of Construction: c. 1835

Builder or Architect: (Give names and biographies, if known)

Original Owner: (Give name and biographies--attach additional sheet if necessary)

Thomas Atkinson-son of Timmaty Atkinson of Smithfield, Virginia. Thomas Atkinson married Sarah English on January 23, 1834. She was the daughter of David English, one of the pioneer settlers of north Baldwin County, a large landowner and a man of influence in the community.

Subsequent Owners (Give name and biographies)

David Pierce English and Mattie Atkinson English-inherited the house and owned it until 1908.

J. H. Till-descendant of an old north Baldwin County family. He was post-master of Tensew until his death in 1948.

Dr. Jacob Till-a colonel in the U. S. Air Force.

State sources of information, giving full bibliographical data:

Kay Nuzum, History of Baldwin County.
Family records.

SECTION III: DESCRIPTION (In each category please state if elements are not original)
YOU MUST PROVIDE US WITH PHOTOGRAPHS OF THE STRUCTURE, SHOWING FRONT, SIDE, REAR
AND NOTABLE DETAILS.

Number of stories Two Foundation Brick piers
Basement None Interior framing or structural system _____
Mortise and tenon and wood frame.

Exterior wall material and design: (Note changes from one floor or wing to another)

Heart pine weatherboarding.

Roof type and covering: Tin-gable.

Roof Trim: (Cornices, vergeboard, brackets, etc.) Boxed cornice.

Chimneys: (Give number, location, and material) Four, two each on east and west sides of house, brick.

Porches: Front (type and description) Five bay, two story porch running full length of the facade. Six square posts, 2 pilasters each story enclosed by hand rail, plain balusters.

Rear (type and description) _____

Side (type and description) _____

Doors: Main entrance (location, description) Middle of first floor, double leaf, one panel, sidelights and transom.

Other entrances: (location, description) Rear opposite front entrance, double leaf, one panel, sidelights and transom.

Windows: (Give types, number for each floor of facade, describe trim) Sash, 6/6, four on each floor, shutters, plain trim.

(Give types, number per floor for rear and sides) Rear same as front except for one sash, 6/6, placed directly above rear door. Sides-four sash, 6/6, plain trim.

INTERIOR FEATURES

Mantels: (Number, location, and description): Eight mantels, one in each room, square openings, pilasters, plain frieze, shelf.

Describe interior window and door trim: Fluted trim with corner blocks.

Stairways (types, locations and features) Straight stairs, center of house, turned newel post, plain balusters.

Wall and ceiling finish: (Include wainscotting, plasterwork, cornices, etc.)

Plaster, some wainscotting.

Flooring: Heart pine. Notable hardware: _____

General setting and orientation: Sheltered among moss draped oaks.

Outbuildings: Smoke house, milk house, servants quarters, carriage house and barn all gone.

Give all alterations and additions: (Be specific, give date of change and original appearance when known) Kitchen attached to rear gone otherwise no structural changes. One chimney has fallen down on west side.

Make a sketch of the floor plan of the building, showing dimensions, related structures, and additions. Also give north arrow and indicate front of the structure.

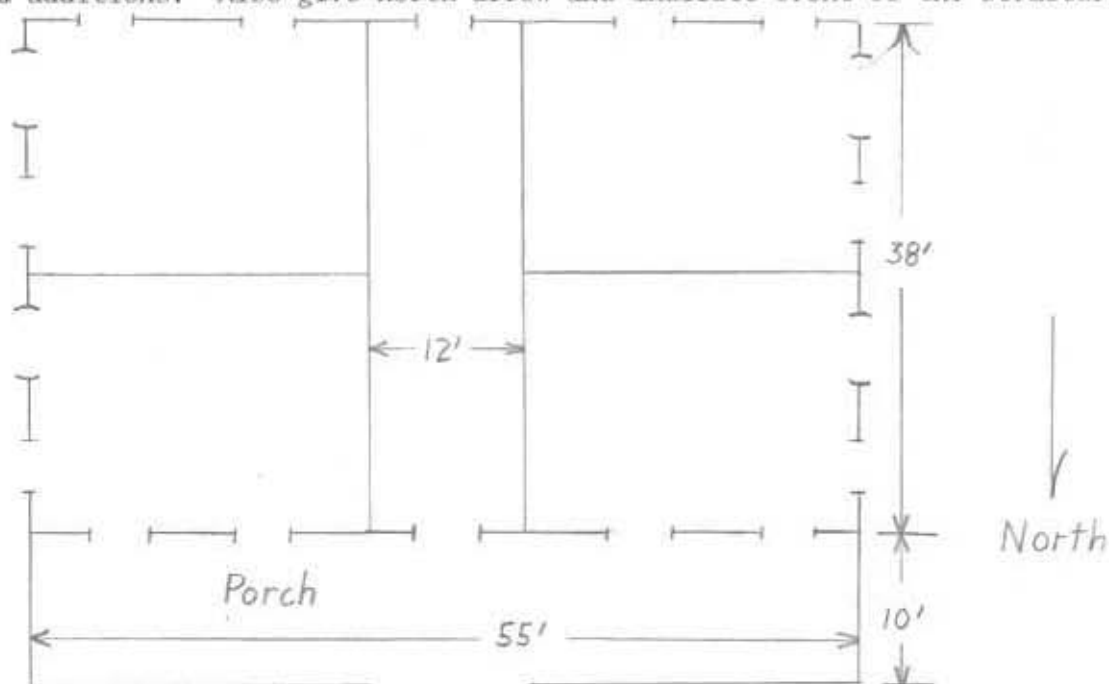

Form prepared by David d. Hastie Date Feb. 8, 1978

Address P. O. Box 69 Phone 937-9464

Town Stockton, Alabama 36579

Organization Baldwin County Historical Society

ALABAMA HISTORIC INVENTORY

Alabama Historical Commission
725 Monroe Street
Montgomery, Alabama 36130

| | | | | | |
|---|--|--|--|--|-----------------------------|
| 1. No. <u>1</u> | | 4. Present Name(s) OLD ENGLISH PLACE | | 1. No. | |
| 2. County Baldwin, | | 5. Other Name(s) ATKINSON-TILL | | | 2. County Baldwin |
| 3. Location of Negatives Stockton, Al. | | | | | |
| 6. Specific Location East of Highway 59 in Bensa Ala. Baldwin, County. Approx. 12 miles north of T 65 | | 16. Thematic Category Architecture | | 2. County Baldwin | |
| 7. City or Town If Rural, Township & Vicinity Tensaw, Al. T2N-R3E | | 17. Date(s) or Period Approx. 1835 or 1836 | | | |
| 8. Site Plan with North Arrow <i>Handwritten site plan showing Tensaw, Old English house, Latham, Stockton, and Hwy 59 approx. 12 mi. north.</i> | | 18. Style or Design Gulf Coast, Federal, Greek Revival influences | | 4. Present Name(s) Atkinson-Till House | |
| 9. Coordinates Lat. _____ Long. _____ U.T.M. Reference Zone _____ Easting _____ Northing _____ | | 19. Architect or Engineer Atkinson and slave labor | | | |
| 10. Site <input type="checkbox"/> Structure <input type="checkbox"/> Building <input checked="" type="checkbox"/> Object <input type="checkbox"/> | | 20. Contractor or Builder Owner and slaves | | 4. Present Name(s) Atkinson-Till House | |
| 11. On National Register? Yes <input type="checkbox"/> No <input checked="" type="checkbox"/> | | 21. Original Use, if apparent Home place | | | |
| 12. On Ala. Register? Yes <input checked="" type="checkbox"/> No <input type="checkbox"/> | | 22. Present Use Hunting camp. | | 4. Present Name(s) Atkinson-Till House | |
| 13. Part of Estab. Hist. Dist.? Yes <input type="checkbox"/> No <input checked="" type="checkbox"/> | | 23. Ownership Public <input type="checkbox"/> Private <input checked="" type="checkbox"/> | | | |
| 14. District Potent'l? Yes <input type="checkbox"/> No <input type="checkbox"/> | | 24. Owner's Name & Address, if known J. R. Till M.D. P.O. Box 1422 Canyon, Lake, Texas | | 4. Present Name(s) Atkinson-Till House | |
| 15. Name of Established District | | 25. Local Contact Baldwin County Historical Society, P.O. Box 69 Stockton, Alabama | | | |
| 41. Further Description of Important Features No change in house except the loss of original kitchen. House has two stories and attic with stairs going through to attic. The attic has a window in each end and its walls could be a least 9 or 10 feet which gives the house a look of two and a half stories. The stairs turn left to go to attic at second floor level. | | 26. Location of Additional Data David R. Hastie P.O. Box 69 | | 5. Other Name(s) Old English Place | |
| 42. History and Significance Age of house and prominence of families who owned and lived in said house. First occupant Thomas Atkinson and wife Sarah English, approx. 1835 or 1836. Last known relative to occupy house was David Pierce English and Mattie XX Atkinson English in 1908. | | 43. Description of Environment and Outbuildings Smoke house, Milk house, servants quarters, carriage house and barn. All gone. The area is primitive with large live oaks and moss. The setting is still very pretty. The picket fence is also gone. | | | |
| 44. Sources of Information Family records-News papers-Legends. History of Baldwin County By. Kay Nuzum | | 45. Prepared By David R. Hastie | | 6. Card Typed | |
| | | 46. Phone 937-9464 | | | |
| | | 47. Date 12-2-77 | | | |
| | | 48. Staff Member | | | |
| | | 49. Revision Date(s) | | | |

ADDITION TO ALABAMA HISTORIC
INVENTORY-

6. Private lane to house about 300 yds. Runs parallel to highway 59. East of Hy.59.
18. Will the Alabama Historical Commission please add style or design. of Old English House
23. Dr. J. R. Till was owner but died November 11th, 1977. He has a wife and his mother is still living. At this time. I don't know who will be given this land and house.
41. Four chimney. Fire places in each room. Stairs go to attic. Two stories then turn to attic. Bannisters gone from front porch. Bannisters intact on second ~~fox~~ floor porch.



BLACKSHER 1.5 MI.
3.81 MI. TO U.S. 84

4446 11



















