



STATE OF ALABAMA

ALABAMA HISTORICAL COMMISSION
725 MONROE STREET
MONTGOMERY, ALABAMA 36130
PHONE: 832-6621



ALABAMA REGISTER OF LANDMARKS AND HERITAGE
Nomination Form

COUNTY Baldwin

NAME: Present Swift-Coles House Historic "Big House"

LOCATION: Street and Number Northeast of Bon Secour
Town (Give directions if rural) Bon Secour

A MAP WITH THE LANDMARK MARKED MUST BE SUBMITTED WITH THIS FORM

CATEGORY: Building (x) Structure () Object () Site () District ()

USE: Present Private residence Historic Private residence

OWNERSHIP: Public () Private (x)

Owner's Name Norman N. Coles

Mailing Address P. O. Box 518
Gulf Shores, AL 36542

INTEGRITY: Original Site (x) Moved () When?

From where? (Give details in significance.)

CONDITIONS: Excellent (x) Good () Fair () Ruins ()

THREATS: No (x) Yes () By What?

RESTORATION WORK: Being considered () Underway (x) Completed () Not planned ()

SURROUNDING ENVIRONMENT: Open land (x) Woodland (x) Scattered buildings ()
High building density () Commercial () Industrial ()
Residential () Rural (x)

Acreage 3 plus

For all categories other than a district and object give a site plan with a North arrow. Show related buildings.

For a district give a verbal boundary description and attach a sketch map of the district.

DESCRIPTION (Continued)

Roof Type: (Gable, Gambrel, Mansard, Flat, Hipped, Combination) Combination.

Roof Covering: (Wood shingle, Asphalt, Tile, Metal, Slate) Slate.

Roof Trim: (Cornices, bargeboard, brackets, etc.) Simple cornice.

Porches: Front (type and description) Wide and recessed with square
beveled columns.

Rear (type and description) Screened, square beveled posts.

Side (type and description) Similar to front.

Doors: Main entrance (location, description) Center of facade, facing the
river; tree/shrub lined road leading to the entrance.

Other entrances (location, description)

Windows: Types and number of each floor of facade Sash, 6/6, shuttered, 8 down,
7 up.

Types and number per floor for sides and rear

Interior: Describe mantels, stairways, wainscoting, plasterwork and any unusual features.

Central hall through both floors; walls are heart pine beaded board
with wainscoting; staircases are heart pine, one in central hall and
the other on the back porch; eight mantels, seven of pine and handmade,
the other is oak, mirrored Victorian design.

Other: Use this space to describe any additions, alterations, outbuildings or other
features of the structure and its surroundings.

Barn, chicken house, wood shed, corn crib and privy

On an additional sheet make a sketch of the floor plan of the building, showing
dimensions if possible.

THIS IS NOT REQUIRED!

DESCRIPTION (Continued)

- STRUCTURE: On a separate sheet of paper give a complete as possible verbal description of the structure. (See examples)
- OBJECT: On a separate sheet of paper give a complete as possible verbal description of the object. (See examples)
- SITE: On a separate sheet of paper give the present description of the site and how the site is believed to have looked during its period of importance.
- DISTRICT: On a separate sheet of paper give a general description of the district. Also needed is a numbered list of the structures in the district corresponding to the sketch map. This listing should include a name for the structure, a date of construction, a brief description, a statement of why the structure is significant, if it is.

A MAP WITH THE LANDMARK MARKED AND PHOTOGRAPHS MUST BE SUBMITTED WITH THIS FORM

Map: A U.S. Geological Survey Map is preferred, but if you are unable to obtain one a county highway map may be used.

Photographs: Black and white, glossy finish, 5 x 7, or 8 x 10, is preferred.

FORM PREPARED BY

Name Norman N. Coles Date 9/5/78
Address P. O. Box 518 Telephone 968-7477
Town Gulf Shores, Al 36542
Organization _____

For Alabama Historical Commission use only

STAFF COMMENTS:

MAP REFERENCE: MAP Foley quadrangle

U. T. M. Reference 16 431250 3354250
Zone Easting Northing

Thematic Category _____

Added to ALABAMA REGISTER _____

NATIONAL REGISTER Potential

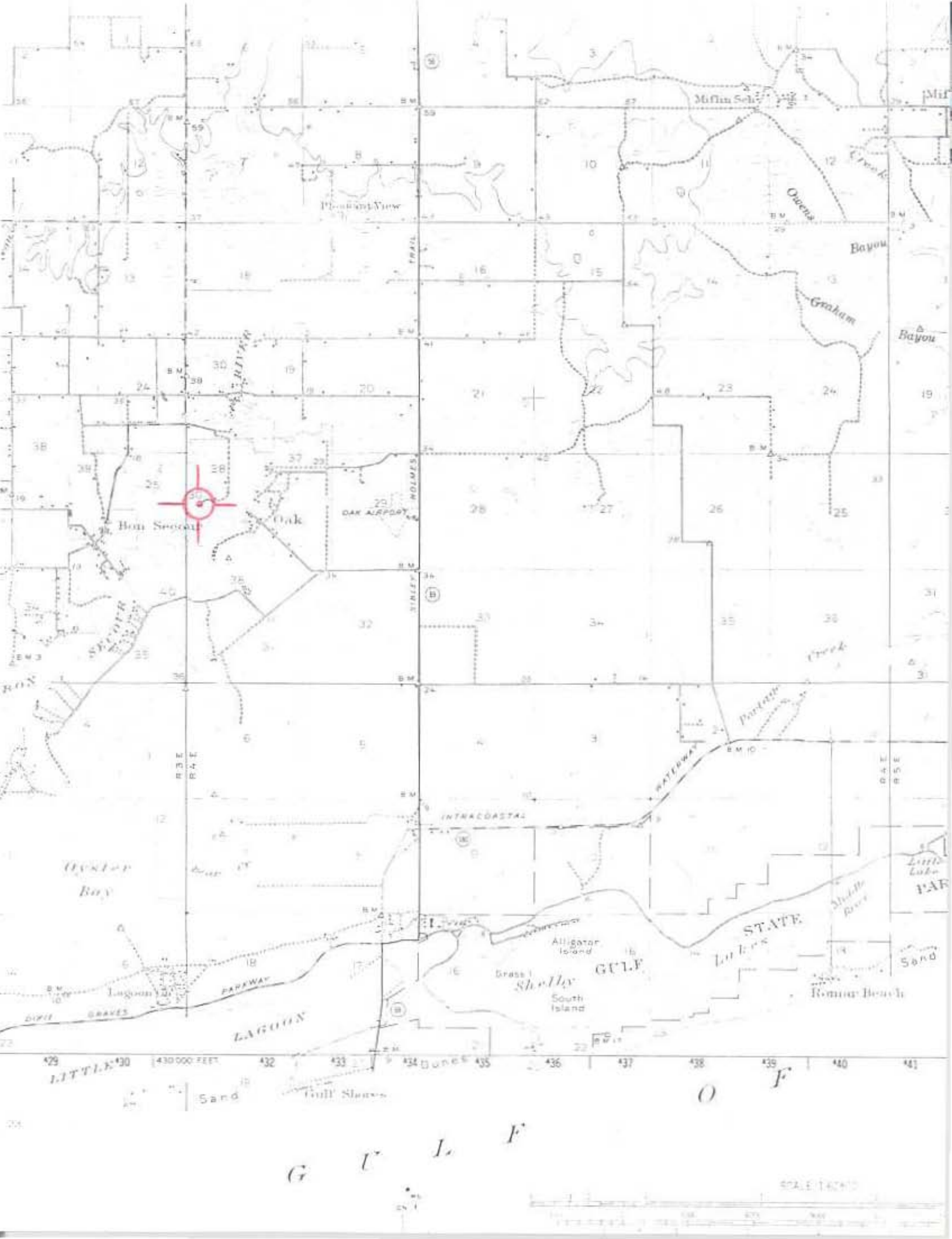

Bon Secour

Pleasant View

Milam Sch.

Owens

Bayou

Graham

Bayou

Oak

OAK AIRPORT

Portage

Oyster Bay

INTRACOASTAL

GULF

STATE

Alligator Island
Grass Island
Shelly
South Island

Mud River

Little Lake

PAR

Romain Beach

429 430 431 432 433 434 435 436 437 438 439 440 441
LITTLE DUNE
Sand Gull Shoals

G U L F

SCALE IN FEET





