

STATE OF ALABAMA

ALABAMA HISTORICAL COMMISSION
725 MONROE STREET
MONTGOMERY, ALABAMA 36130
PHONE: 832-6621



ALABAMA INVENTORY AND WORKSHEET FOR LANDMARKS

COUNTY ButlerPRESENT NAME Liberty United Methodist ChurchHISTORIC NAME Liberty Chapel ChurchLOCATION (Street and number) Kolb City Road from Highway 10 WestTOWN (Give directions if rural) West of Greenville, 1/2 mi past city limits on Hwy 10 West of I-65, take 1st paved road to left--church is located about 300ydsPRESENT USE ChurchHISTORIC USE ChurchOWNERSHIP: Public () Private () Public acquisition being considered ()OWNER'S NAME United Methodist ConferenceMAILING ADDRESS Rt. 1, Box 252 (Address of trustee, Aubrey C. Cheatham), Greenville, Al. 36037CONDITION: Excellent () Good () Fair () Ruins ()INTEGRITY: Original Site () Moved () When? date unknown
site moved nearer to sections 29 and 20 lines--later deeded.
From where? site nearby Give details in significance.
The old log cabin Church-school burned down.THREATS: No () Yes () By What?Continuous restorationRESTORATION WORK: Being considered () Underway () Completed () Not planned ()SURROUNDING ENVIRONMENT: Open land () & Woodland () Scattered buildings ()
High building density () Commercial () Industrial ()
Residential () Rural ()If there are numerous buildings in the area, could this structure be part of a Historic District? YesSIGNIFICANCE: Why is this important () associated with events, persons, or movements
United Methodist Local () State () National ()
() a good example of a type or style of structure
() other

Explain: (Expand on the significance of the building. If architecturally significant, give details being very specific. Additional data on what aspects of the community's development the building represents, or a specific event, trend or person related to the building's importance.)

Standard colonial-rural church design of this county.

Date of Construction: Between 1858-1859
Builder or Architect: (Give names and biographies, if known)
Church members

Original Owner: (Give name and biographies--attach additional sheet if necessary)
The land was a land patent to Asa Skinner (copy attached) dated 1858, who later deeded the land to Methodist Episcopal Church, South (years after church was built). Copy of deed attached. Also copy of marriage certificated which show that couples were married in the church in 1861, also marked graves of persons who died in 1861 who are buried in the cemetary behind the church. (See attached list).
(NOTE: All attached records are taken from "The History of Reddock Springs (Liberty), Butler County, Alabama from 1817" (published 1975) written by Martha Pate Cheatham (Mrs. Aubrey C. Cheatham)

Subsequent Owners (Give name and biographies)
Liberty United Methodist Church, member of the Alabama-West Florida Conference.

State sources of information, giving full bibliographical data:
Land Patent, Church land deed, cemetary records, marriage records as shown in copies attached, described above.

SECTION III: DESCRIPTION (In each catagory please state if elements are not original)
YOU MUST PROVIDE US WITH PHOTOGRAPHS OF THE STRUCTURE, SHOWING FRONT, SIDE, REAR AND NOTABLE DETAILS.

Number of stories one Foundation Huge virgin heart pine,
outside pillars of brick.
Basement no basement Interior framing or structural system _____
Virgin pine

Exterior wall material and design: (Note changes from one floor or wing to another)
Pine weatherboards (1x6)

Roof type and covering:

Roof Trim: (Cornices, vergeboard, brackets, etc.)

Chimneys: (Give number, location, and material)

The original chimney was for a wood burning heater with flu
(now removed and central heating and air conditioning installed)

Porches: Front (type and description) None.

Rear (type and description) _____

Side (type and description) _____

Doors: Main entrance (location, description) Double doors with arched window
panes above.

Other entrances: (location, description)

None

Windows: (Give types, number for each floor of facade, describe trim)

four windows each side, two in front, two in back. Box facing.

(Give types, number per floor for rear and sides)

INTERIOR FEATURES

Mantels: (Number, location, and description):

None

Describe interior window and door trim:

Box facing

Stairways (types, locations and features)

None

Wall and ceiling finish: (Include wainscoting, plasterwork, cornices, etc.)

Original: walls and ceiling 1x4 pine lumber
Now covered in panelling

Flooring: _____ Notable hardware: _____

1x4 pine lumber now covered with carpet

General setting and orientation:

Pulpit, piano and choir area raised two steps up with prayer rail
around pulpit area.
(Now entire church floor is carpeted)

Outbuildings:

None

Give all alterations and additions: (Be specific, give date of change and original appearance when known)

Walls panelled, ceiling celotex 1972
Air condition/heating central system 1974
Carpet 1975
Cement walk 1977

Make a sketch of the floor plan of the building, showing dimensions, related structures, and additions. Also give north arrow and indicate front of the structure.

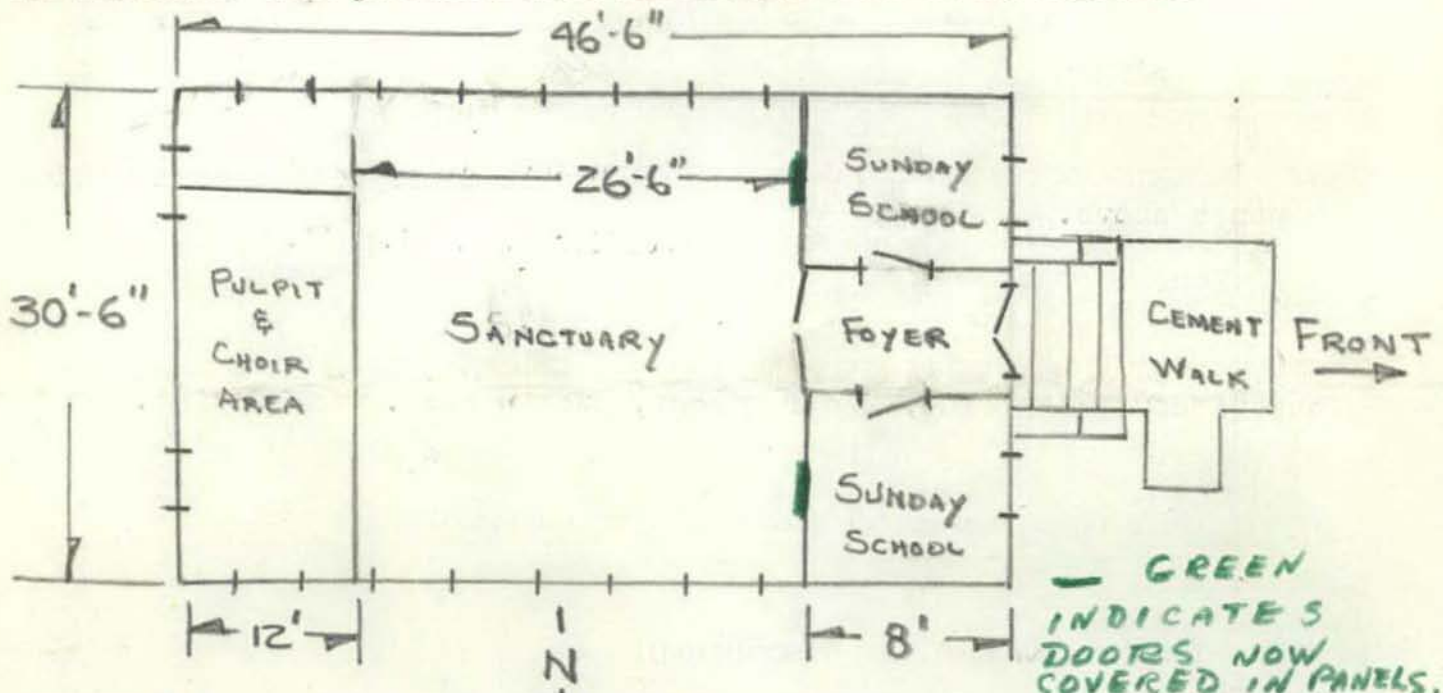

Form prepared by Mrs. Aubrey C. Cheatham with assistance Date Jan 27, 1978

Address Route 1, Box 252, Greenville, Alabama 36037 Phone 382-5936

Town Community of Liberty just west of Greenville, Al.

Organization Liberty United Methodist Church

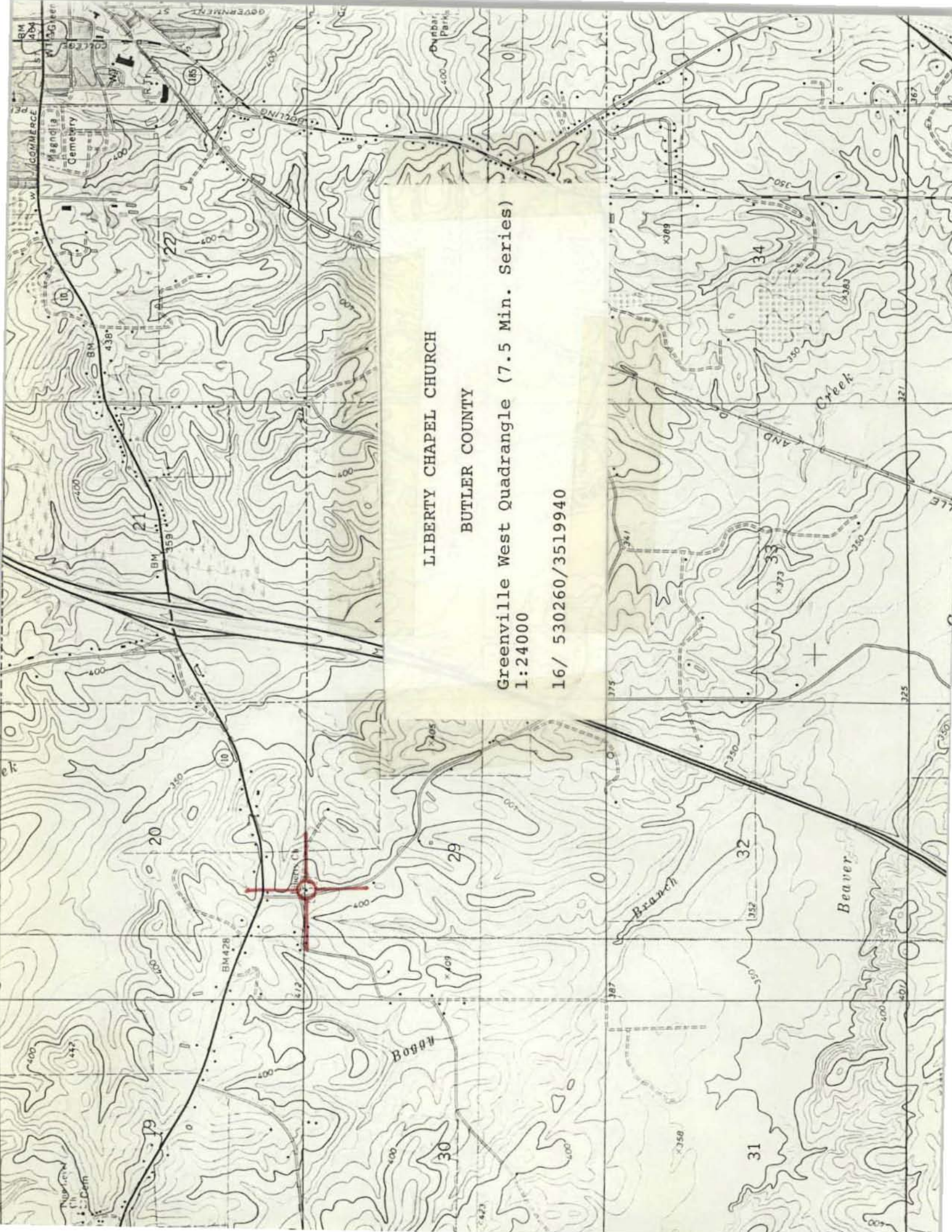

LIBERTY CHAPEL CHURCH

BUTLER COUNTY

Greenville West Quadrangle (7.5 Min. Series)
1:24000

16/ 530260/3519940