



RECEIVED
MAY 15 1986

STATE OF ALABAMA

ALABAMA HISTORICAL COMMISSION
725 MONROE STREET
MONTGOMERY, ALABAMA 36130
PHONE: 261-3184

ALABAMA REGISTER OF LANDMARKS AND HERITAGE
Nomination Form

COUNTY Colbert

NAME: Present None Historic Glencoe Plantation
Keller Cemetery

LOCATION: Street and Number Tuscumbia, Alabama

Town (Give directions if rural) 4 miles west on US 72 at Vulcan Materials

A MAP WITH THE LANDMARK MARKED MUST BE SUBMITTED WITH THIS FORM

CATEGORY: Building () Structure () Object () Site (X) District ()

USE: Present None Historic None

OWNERSHIP: Public () Private (X)

Owner's Name Walker Lumber Company

Mailing Address Old Highway 72

Tuscumbia, Al 35674

INTEGRITY: Original Site (X) Moved () When? _____

From where? _____ (Give details in significance.)

CONDITIONS: Excellent () Good (X) Fair () Ruins ()

THREATS: No (X) Yes () By What? _____

RESTORATION WORK: Being considered () Underway (X) Completed () Not planned ()

SURROUNDING ENVIRONMENT: Open land () Woodland () Scattered buildings (X)
High building density () Commercial () Industrial (X)
Residential () Rural ()

Acreage Less than one

For all categories other than a district and object give a site plan with a North arrow.
Show related buildings.

For a district give a verbal boundary description and attach a sketch map of the district.

SIGNIFICANCE:

Why is this landmark significant? (X) associated with events, persons, or movements
Local (X) State (X) National (X)
() a good example of a type or style of structure
() other

Explain: (Briefly state why the above is true)

MARY FAIRFAX MOORE,

David Keller (Helen Keller's grandfather) buried here. Keller's wife was a descendant of
granddaughter of Martha Washington, cousin to Robert E. Lee. ~~Built first~~
railroad west of Alleghenys. *stockholder in*

*Gov. Alex-
and-
Spotswood*

Date of Construction or Period of major importance. ^{c 1818}
1790-1854

Architect or Builder (Give name and biographies, if known) Wall built by slave labor.

Give a complete but concise history of the Landmark. Include information on important people and events associated with the landmark. (USE ADDITIONAL SHEETS IF NECESSARY)

Family cemetery for Kellers & McDonalds who owned plantation called "Glencoe".
McDonald was brother-in-law of Keller and both were one of founding fathers
in Colbert County. See attached records.

State sources of information, giving full bibliographical data:

See attached records.

DESCRIPTION: PHOTOGRAPHS OF THE LANDMARK MUST BE SUBMITTED WITH THIS FORM.

Complete as directed below for each category.

BUILDING:

Number of stories N/A Foundation _____ Basement _____

Wall Material: (Note changes from one floor or wing to another)
(clapboard, brick, stone, wood shingle, board and batten, stucco over
wood or brick, metal, logs)

Structural System: (If known)

Wood frame () Load-bearing masonry () Iron or Steel ()

DESCRIPTION (Continued)

Roof Type: (Gable, Gambrel, Mansard, Flat, Hipped, Combination)

Roof Covering: (Wood shingle, Asphalt, Tile, Metal, Slate)

Roof Trim: (Cornices, bargeboard, brackets, etc.)

Porches: Front (type and description) _____

Rear (type and description) _____

Side (type and description) _____

Doors: Main entrance (location, description)

Other entrances (location, description)

Windows: Types and number of each floor of facade

Types and number per floor for sides and rear

Interior: Describe mantels, stairways, wainscoting, plasterwork and any unusual features.

Other: Use this space to describe any additions, alterations, outbuildings or other features of the structure and its surroundings.

On an additional sheet make a sketch of the floor plan of the building, showing dimensions if possible.

THIS IS NOT REQUIRED!

DESCRIPTION (Continued)

STRUCTURE: On a separate sheet of paper give a complete as possible verbal description of the structure. (See examples)

OBJECT: On a separate sheet of paper give a complete as possible verbal description of the object. (See examples)

SITE: On a separate sheet of paper give the present description of the site and how the site is believed to have looked during its period of importance.

DISTRICT: On a separate sheet of paper give a general description of the district. Also needed is a numbered list of the structures in the district corresponding to the sketch map. This listing should include a name for the structure, a date of construction, a brief description, a statement of why the structure is significant, if it is.

A MAP WITH THE LANDMARK MARKED AND PHOTOGRAPHS MUST BE SUBMITTED WITH THIS FORM

Map: A U.S. Geological Survey Map is preferred, but if you are unable to obtain one a county highway map may be used.

Photographs: Black and white, glossy finish, 5 x 7, or 8 x 10, is preferred.

FORM PREPARED BY

Name Paul Scott c/o Vulcan Materials Co. Date 1-30-86
Address P. O. Box 110 Telephone 383-7884
Town Tuscumbia, Al 35674
Organization Colbert Co. Historical Society

For Alabama Historical Commission use only

STAFF COMMENTS:

MAP REFERENCE: MAP

U. T. M. Reference Zone Easting Northing

Thematic Category

Added to ALABAMA REGISTER

NATIONAL REGISTER Potential

Glencoe Plantation

Description - ~~Keller~~ Cemetery

Located approximately 1/2 mile south of US 72 West: near Tuscumbia on Walker Lumber Company property that is leased to Vulcan Materials Company.

The cemetery is surrounded by a 4' high stone wall that was cut and laid by slave labor. It was started in the early 1800's. There are eight graves inside the cemetery.

When Vulcan started leasing the surrounding property in 1964, the cemetery was grown up by vines and trees to the extent that few stones could be seen. No one had any interest in restoration.

In 1984, Vulcan began cleanup and restoration. In 1985, most all the work had been done. With the permission of the survivors and heirs, we tore down surrounding wall, removed the tomb stones and cut out all trees and vines. We then put 1' of good top soil on the site, planted sod and replaced the tombs in the exact spot they came from. We then reconstructed the wall back to original size and put up a steel gate.

See Accompanying Photos

As June each year brings the week long Helen Keller Festival in Tuscumbia, the heirs would like for this cemetery to be placed on the Keller Tour. We believe, due to the historical significance of the site, being on the register would enhance the entire Keller Festival Week.

Site Plan - Keller Cemetery

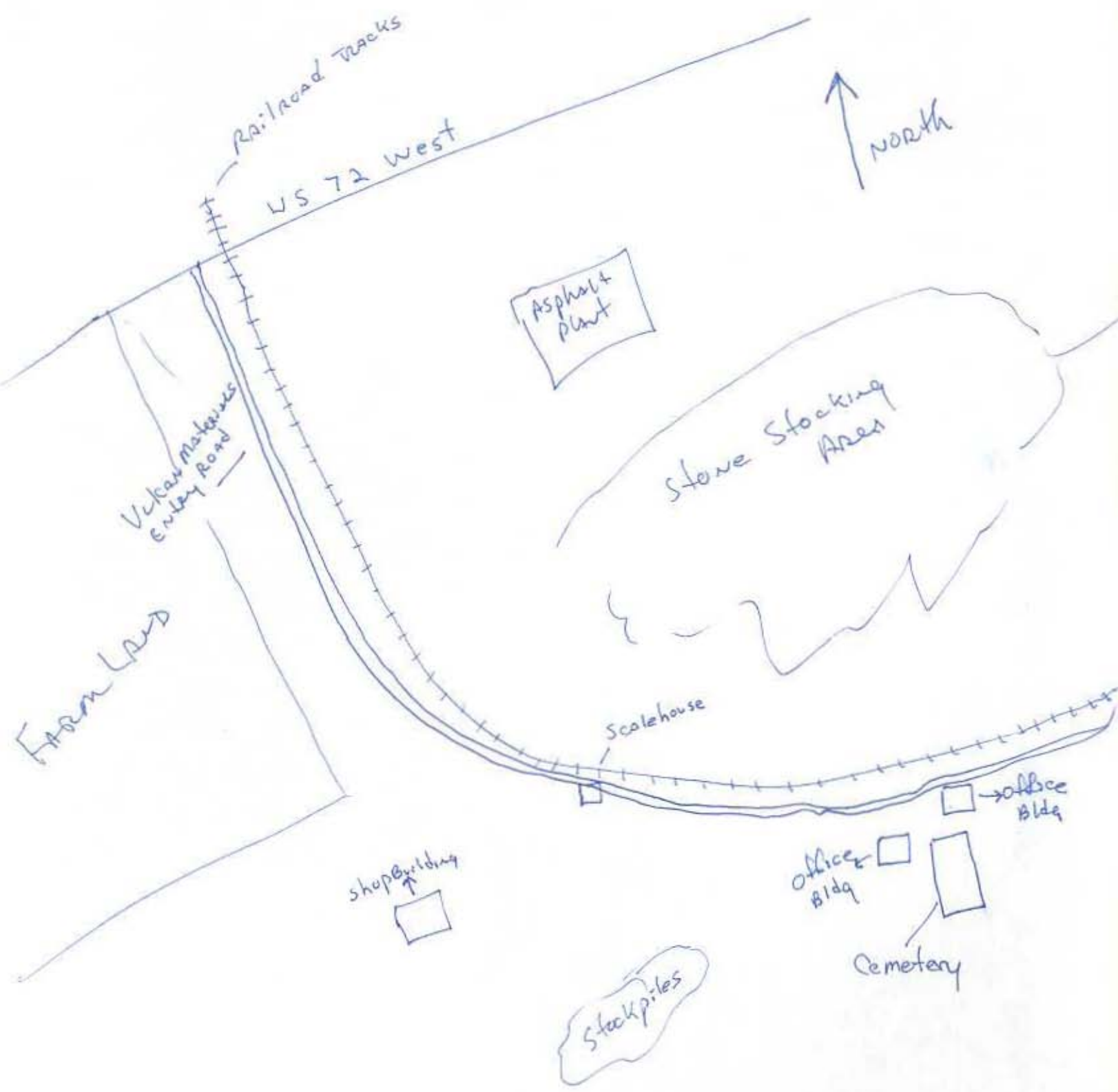



Keller Cemetery

LEGEND

- ROADS AND ROADWAY FEATURES**
 - UNIMPROVED ROAD
 - IMPROVED AND DRAINAGE ROAD
 - PAVED SURFACE ROAD
 - GRAVEL AND DIRT ROAD
 - ROADWAY ROAD - LOW TYPE
 - RAILROAD BRIDGE
 - DIVIDED HIGHWAY
 - AL ALONE DIVIDED HIGHWAY
 - SIDE ROADS AND STREETS
 - INTERCHANGE
- RAILROADS**
 - RAILROAD - SINGLE TRACK
 - RAILROADS IN DISCONTINUED
 - RAILROAD CROSSING
 - RAILROAD BRIDGE
 - RAILROAD TUNNEL
- BOUNDARIES**
 - COUNTY BOUNDARY
 - INCORPORATED CITY BOUNDARY
 - UNINCORPORATED CITY BOUNDARY
 - STATE FOREST BOUNDARY
 - NATIONAL OR STATE FOREST BOUNDARY
 - STATE PARK BOUNDARY
 - MILITARY RESERVATION BOUNDARY
 - STATE CAPITAL
 - OTHER TOWNS AND VILLAGES
 - INCORPORATED CITY OR TOWN
 - UNINCORPORATED DELIMITED URBAN AREA
 - PUBLIC SERVICE FACILITIES
 - CONTINUOUS
 - WATER TANK OR STAND PIPE
 - PIPE LINE - GAS
 - PIPE LINE - OIL
 - TRUCKING ROUTE
 - POWER PLANT
 - UNDERGROUND TELEPHONE CABLE
 - MAJOR TELEPHONE STATION
 - EDUCATIONAL AND CORRECTIONAL
 - SCHOOLHOUSE
 - CONSOLIDATED OR LARGE SCHOOL
 - OTHER EDUCATIONAL INSTITUTIONS
 - TOWN HALL OR COMMERCE CENTER
 - AGRICULTURAL EXPERIMENT STATION
 - PRISON OR CORRECTIONAL INSTITUTION
- CITY AND VILLAGE CENTERS**
 - STATE CAPITAL
 - OTHER TOWNS AND VILLAGES
 - INCORPORATED CITY OR TOWN
 - UNINCORPORATED DELIMITED URBAN AREA
- CONSERVATION AND RECREATION**
 - ADDRESS PARK - PAVIC GROUNDS
 - PLAYGROUND, BALL FIELD, ETC.
 - ACTIVE RECREATION CENTER
 - SCENIC SITE - OVERLOOK
 - TOURIST OR VISITOR CENTER
 - CAMP OR LODGE - STATE, CO-COUNTRY
 - FOREST TRAILER STATION
 - RECREATION OR CAMPGROUND
 - PROSPECT PEARL AND LOGCUT TOWER
 - FOREST INTERPRETER - BARN
 - FISH HATCHERY - POND
 - GRAND PRESERVE
 - GOLF COURSE OR COUNTRY CLUB
 - RECREATION CENTER
 - AMUSEMENT PARK OR MALL
 - PAVING TRACK OR SPEEDWAY
 - DRIFT OR THEATRE
 - RECREATION SITE
- MISCELLANEOUS**
 - GRANARY
 - SHED
 - BARRAGE OR RUBBER DAM
 - SCRAM WITH JORDANS
 - AUTOMOBILE SHOWROOM
 - GRAN ELEVATOR
 - SHIPPING CENTER
 - REST AREA
 - TRAVELER OR TRAVELER STATION
 - BEACH MARK - WITH ELEVATION
- DRAINAGE AND NATURAL FEATURES**
 - INTERMITTENT STREAM
 - NARROW STREAM
 - WIDE STREAM - CREEK
 - LAKE, RESERVOIR OR POND
 - MARSH OR SWAMP
 - DEEP OR LAND
 - PERMANENT ELEVATION - FEET
 - MOUNTAIN RANGE
 - SINK
- ROAD SYSTEM DESIGNATION**
 - INTERSTATE HIGHWAY SYSTEM
 - U. S. NUMBERED SYSTEM
 - STATE HIGHWAY SYSTEM
 - COUNTY ROAD NUMBER
 - FEDERAL AID PRIMARY SYSTEM
 - FEDERAL AID SECONDARY SYSTEM
 - NATIONAL FOREST HIGHWAY
- HIGHWAY BRIDGES**
 - HIGHWAY BRIDGE - GENERAL
 - RAILROAD BRIDGE
 - TRUSS OR GIRDER IN STEEL, WOOD
 - CASTLE BRIDGE
 - CORNERED BRIDGE
 - HIGHWAY GRADE SEPARATION
- MISCELLANEOUS STRUCTURES**
 - RAILROAD TUNNEL
 - CAUSEWAY
 - MINOR DRAINAGE STRUCTURE
 - FORD, ROAD EXISTENCE
 - CATTLE GUARD
 - GATE CROSSING ROAD
- NAVIGATION**
 - SHIP AND BRIDGE LINES
 - PIER, WHARF OR LAUNCH
 - FERRY-OPERATED BY TOLLS
 - RAILROAD TUNNEL
 - LOCK
 - LOCKAGE
 - WATERWAY
 - WATERWAY
 - WATERWAY
 - WATERWAY
 - WATERWAY
- AIRPORTS**
 - AIRPORT - GENERAL
 - AIRPORT - COMMERCIAL OR MILITARY
 - AIRFIELD - LIMITED FACILITIES
 - LANDING AREA OR STRIP

**GENERAL HIGHWAY MAP
COLBERT COUNTY
ALABAMA**

PREPARED BY THE
STATE OF ALABAMA HIGHWAY DEPARTMENT
BUREAU OF PLANNING AND PROGRAMMING
SURVEYING AND MAPPING DIVISION
IN COOPERATION WITH THE
U. S. DEPARTMENT OF TRANSPORTATION
FEDERAL HIGHWAY ADMINISTRATION



SCALE
1 2 3 4 MILES
0 10000 20000 30000 FEET

COUNTY POPULATION, 1970 CENSUS 49,432
COUNTY AREA IN SQUARE MILES 616

1978

Chart by NATIONAL OCEAN SURVEY and ALABAMA HIGHWAY DEPARTMENT
Township Meridian Projection, 1927 North American Datum, 30,000 foot grid based on Alabama (West) rectangular coordinate system.
Copyright by photographists within two aerial photographs taken 1975. First revision 1978.







