

ALABAMA REGISTER OF LANDMARKS AND HERITAGE

Nomination Form

RECEIVED

Added 5-19-99

APR 15 1999

1. Name

historic HOPE WELL CHURCH
and/or common

Ala. Historical Commission

2. Location

street & number 17481 HWY. 21 P O BOX 46
city, town FURMAN ---vicinity of
state ALABAMA county WILCOX zip 36741

3. Classification

Category	Ownership	Status	Present Use	
<input type="checkbox"/> district	<input checked="" type="checkbox"/> public	<input checked="" type="checkbox"/> occupied	<input type="checkbox"/> agriculture	<input type="checkbox"/> museum
<input checked="" type="checkbox"/> building(s)	<input type="checkbox"/> private	<input type="checkbox"/> unoccupied	<input type="checkbox"/> commercial	<input type="checkbox"/> park
<input type="checkbox"/> structure	<input type="checkbox"/> both	<input type="checkbox"/> work in progress	<input type="checkbox"/> educational	<input type="checkbox"/> private residence
<input type="checkbox"/> site	Public Acquisition	Accessible	<input type="checkbox"/> entertainment	<input checked="" type="checkbox"/> religious
<input type="checkbox"/> object	<input type="checkbox"/> in process	<input type="checkbox"/> yes: restricted	<input type="checkbox"/> government	<input type="checkbox"/> scientific
	<input type="checkbox"/> being considered	<input checked="" type="checkbox"/> yes: unrestricted	<input type="checkbox"/> industrial	<input type="checkbox"/> transportation
		<input type="checkbox"/> no	<input type="checkbox"/> military	<input type="checkbox"/> other:

4. Owner of Property

name Phone number
street & number
city, town ---vicinity of zip

5. Floor plan & site plan. Use space below to sketch floor plan and site plan or attach additional sheet.

SEE ATTACHMENT

6. Description (See attached instructions for specific guidelines.)

Condition
 excellent
 good
 fair

deteriorated
 ruins
 unexposed

Check one
 unaltered
 altered

Check one
 original site
 moved date _____

Describe the present and original (if known) physical appearance.

The Hope Well Community Church is a one-story frame building with veneer imitation brick. The front appearance include twin towers with a porch between. The towers house restrooms, which were added in 1983.

The sanctuary is wood framed, veneered with walls and ceiling of 4 x 8 wall paneling. The floors are 1 x 4 center, matched with partial carpet. The top dimensions are 20 x 48 used as a fellowship hall, added in 1992.

The foundation of this church is wood pillars with bass wood.

The original building is believed to be constructed in 1864, according to a register and also believed to be similar to the structure of the original building.

orig floor - deteriorated

orig pews
modified pulpit

no cemetery

still active congregation
become Church of God in Christ -
currently non-denominational -
approx 35 members meet weekly
school assoc w/ church at one time
Hopewell School - on right of church

7. Significance (See attached instructions for specific guidelines.)

Period	Areas of Significance-Check and justify below			
<input type="checkbox"/> prehistoric	<input type="checkbox"/> archeology-prehistoric	<input type="checkbox"/> community planning	<input type="checkbox"/> landscape architecture	<input checked="" type="checkbox"/> religion
<input type="checkbox"/> 1400-1499	<input type="checkbox"/> archeology-historic	<input type="checkbox"/> conservation	<input type="checkbox"/> law	<input type="checkbox"/> science
<input type="checkbox"/> 1500-1599	<input type="checkbox"/> agriculture	<input type="checkbox"/> economics	<input type="checkbox"/> literature	<input type="checkbox"/> sculpture
<input type="checkbox"/> 1600-1799	<input checked="" type="checkbox"/> architecture	<input type="checkbox"/> education	<input type="checkbox"/> military	<input checked="" type="checkbox"/> social/
<input type="checkbox"/> 1700-1799	<input type="checkbox"/> art	<input type="checkbox"/> engineering	<input type="checkbox"/> music	<input type="checkbox"/> humanitarian
<input checked="" type="checkbox"/> 1800-1899	<input type="checkbox"/> commerce	<input type="checkbox"/> exploration/settlement	<input type="checkbox"/> philosophy	<input type="checkbox"/> theater
<input type="checkbox"/> 1900-	<input type="checkbox"/> communications	<input type="checkbox"/> industry	<input type="checkbox"/> politics/government	<input type="checkbox"/> other (specify)

Specific dates**Builder/Architect**

Statement of Significance (in one paragraph).

The Hope Well Community Church is eligible for listing on the Alabama Register of Landmarks and Heritage for its religious, social, and architectural significance.

The church was established in 1864 and known as the first site for blacks to worship together in their community. Its twin towers depicts an architectural example of the early twentieth-century rural black church construction.

HISTORICAL SUMMARY

In 1864, the year Hope Well was established, the church stood as a foundation for the black community. It has great significance because the blacks and whites had to worship together, then Hope Well became the site for their people to worship and pray privately. This one story building was constructed by the men in the community and holds its same form today.

8. Major Bibliographical References

9. Geographical Data

Acree of nominated property LESS THAN ONE ACRE

Quadrangle name _____

Enclose map showing location of property. (city or county map, state highway department map, or USGS map)

10. Form Prepared By

name/title Valerie Smith
organization _____ date _____
street & number _____ telephone 833-2657 (w)
city or town _____ state _____ zip _____

11. Please submit color slides of the property with this form.

Color slides are essential to the review process.

12. Please return ALABAMA REGISTER form and documentation to:

Alabama Register Coordinator
Alabama Historical Commission
468 South Perry Street
Montgomery, Alabama 36130-0900

HOPE WELL HOLINESS CHURCH

Hope Well was originally - Hope Well AME Zion. It was founded around 1850. During this time blacks and whites worshipped together. The whites moved toward the west of town, therefore the distant was too far for the blacks to travel by foot so they asked for their own place of worship.

The community got together and started the first black church Hope Well AME Zion. The trustees of the church during this time are not certain, but this is a continuing research. From this church, the Union Burial society was organized. The purpose was to take care of the sick and help in the expense of burying the dead. It was reported that when someone would pass away, the men in the community would get together and tear down barns or what was available and make boxes to bury the dead. The society changed this problem because if you were a member, you could pay your small fee and they would take care of it. Society members would help take care of the sick, wash clothes, cut fire wood and take care of the children if needed. To be a member of the society was and still is an honor.

The Hope Well Burial Ground was organized during this time. Also organized was The Hope Well School. They educated children from grades one through six. Some teachers of the Hope Well School were:

Ms. Susie Wright	Ms. Anna Greene	Ms. Mary Irby
Ms. Atlean Johnson	Ms. Inez Johnson	Ms. Fitzpatrick
Ms. Madison	Ms. Abby	Pro Pierce
Mr. Earnest Hale	Mr. John Thomas	Mr. Roosevelt Johnson

Family was extremely important during this time. Family life was centered around the church. Such families as the Savage, Purifoy, Bogan, Gulley, Palmer, Ray, Hall, Hale, Smith, Lee, Powell, Johnson, Crum, Snow, Sanders, Wright, Anderson, Banks, Lott, Mobley, Soles, Jones, Burgess, Calhoun, Moorner, and Butler help to unify the community by being apart of this church.

It was reported that the landowner who inherited the land surrounding Hope Well Church would come and minister to the church. They called him a prophet because his vision would come to pass. Mr. Simpson always took time to talk to the people on his plantation teaching them to be self-sufficient and independent. The people were poor but very proud with great moral values. The people were also very intelligent. During the research, it was noted that the readings on the tomb stones were very poetic, such as, "If you put God first in your life he will be there when people fail you, make him your leaning post" and "In the last days the wise would live off the fools."

The resources for getting information on the history was very limited because the elderly people cannot remember very much. Therefore if you have any information that would be helpful to us, please let us know.

We are embarking upon a great task of building a new church. I know that through our prayers and the prayers of the older saints and God's help we can this.

God Bless You.

Former Pastors of Hope Well Church

Rev Amos Snowden	Rev. Davis	Rev. Crum	Rev. Woodon
Rev. Shifler	Rev. Lewis	Elder Gordon	Elder Dale
Rev. Clemmons	Rev. Simmons	Sis. Mitchell	Sis. Adams

Eld John Grayson

Present Day Pastor - ~~Elder John E. Grayson~~ Elder Ezell Powell

Please send any information to Doris Smith, P.O. Box 4, Furman, AL 36741 or call (334) 746-2205.

RECEIVED

MAY 17 1999

HOPE WELL CHURCH
Furman, Wilcox County

The Hope Well Church is eligible for listing on the AR under Criteriion A in the area of religion and ethnic heritage. It depicts a popular religious form, a twin towered gable front, but renovations have obscured its original materials. Possibly the original clapboard siding is intact underneath the present rolled asphalt and could be restored. The current structure dates from around the turn of the century, but the congregation was established at an earlier date. It is significant as an early African American religious institution, the congregation dating to the Reconstruction or, possibly, antebellum years. It has been maintain to the present by church members and continues to facilitate worship services.

T.12 N.-R.11 E.

DALLAS COUNTY

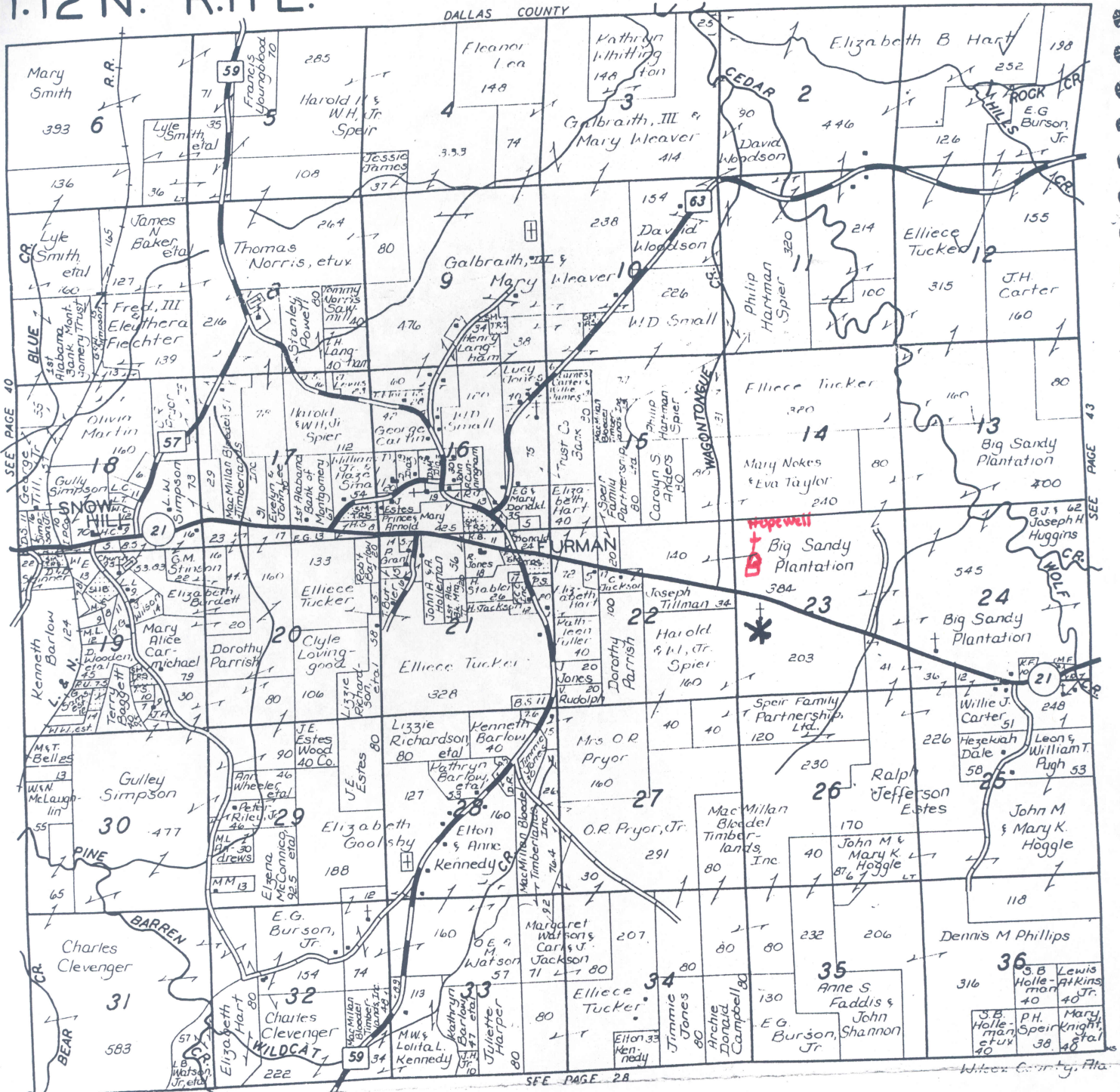

© 1991 Rockford Map Publs, Inc.

SEE PAGE 28

White County, Ala



SAM WILKINSON, C.L.U.
Agent

210 Claiborne Street, P.O. Box 818
Camden, Alabama 36726

Office: (205) 682-4713 - Residence: (205) 682-9254

STATE FARM INSURANCE COMPANIES
HOME OFFICES: BLOOMINGTON, ILLINOIS

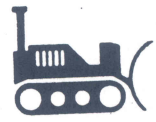

J R D Contracting, Inc.

Sand, Gravel, Topsoil, Forestry Sitework, Dozer Work, Trucking
P.O. BOX 103, CAMDEN, ALABAMA 36726
PHONE: (205) 682-9202

John R. Dailey

