

# ALABAMA REGISTER OF LANDMARKS & HERITAGE NOMINATION FORM

Alabama Historical Commission  
725 Monroe Street  
Montgomery, Alabama 36130

SEE INSTRUCTIONS IN *HOW TO COMPLETE NATIONAL REGISTER FORMS*  
TYPE ALL ENTRIES -- COMPLETE APPLICABLE SECTIONS

## 1 NAME

HISTORIC

Kaster

AND/OR COMMON

## 2 LOCATION

STREET & NUMBER

Broad Street

CITY, TOWN

Camden

NOT FOR PUBLICATION

CONGRESSIONAL DISTRICT

STATE

Alabama

VICINITY OF

CODE

36726

COUNTY

Wilcox

CODE

## 3 CLASSIFICATION

for sale: see enclosure

CATEGORY	OWNERSHIP	STATUS	PRESENT USE	
<input type="checkbox"/> DISTRICT	<input type="checkbox"/> PUBLIC	<input type="checkbox"/> OCCUPIED	<input type="checkbox"/> AGRICULTURE	<input type="checkbox"/> MUSEUM
<input checked="" type="checkbox"/> BUILDING(S)	<input checked="" type="checkbox"/> PRIVATE	<input checked="" type="checkbox"/> UNOCCUPIED	<input type="checkbox"/> COMMERCIAL	<input type="checkbox"/> PARK
<input type="checkbox"/> STRUCTURE	<input type="checkbox"/> BOTH	<input type="checkbox"/> WORK IN PROGRESS	<input type="checkbox"/> EDUCATIONAL	<input type="checkbox"/> PRIVATE RESIDENCE
<input type="checkbox"/> SITE	<b>PUBLIC ACQUISITION</b>	<b>ACCESSIBLE</b>	<input type="checkbox"/> ENTERTAINMENT	<input type="checkbox"/> RELIGIOUS
<input type="checkbox"/> OBJECT	<input type="checkbox"/> IN PROCESS	<input type="checkbox"/> YES: RESTRICTED	<input type="checkbox"/> GOVERNMENT	<input type="checkbox"/> SCIENTIFIC
	<input type="checkbox"/> BEING CONSIDERED	<input type="checkbox"/> YES: UNRESTRICTED	<input type="checkbox"/> INDUSTRIAL	<input type="checkbox"/> TRANSPORTATION
		<input checked="" type="checkbox"/> NO	<input type="checkbox"/> MILITARY	<input checked="" type="checkbox"/> OTHER

## 4 OWNER OF PROPERTY

NAME

Mrs. Lucille Skinner

STREET & NUMBER

CITY, TOWN

Butler

VICINITY OF

STATE

Alabama

## 5 LOCATION OF LEGAL DESCRIPTION

COURTHOUSE,  
REGISTRY OF DEEDS, ETC.

Wilcox County Courthouse

STREET & NUMBER

Broad Street

CITY, TOWN

Camden

STATE

Alabama

## 6 REPRESENTATION IN EXISTING SURVEYS

TITLE

Historic American Buildings Survey

DATE

(HABS) 1937

FEDERAL  STATE  COUNTY  LOCAL

DEPOSITORY FOR  
SURVEY RECORDS

Library of Congress

CITY, TOWN

Washington

STATE

D. C.

## 7 DESCRIPTION

CONDITION		CHECK ONE	CHECK ONE
<input type="checkbox"/> EXCELLENT	<input checked="" type="checkbox"/> DETERIORATED	<input type="checkbox"/> UNALTERED	<input checked="" type="checkbox"/> ORIGINAL SITE
<input type="checkbox"/> GOOD	<input type="checkbox"/> RUINS	<input checked="" type="checkbox"/> ALTERED	<input type="checkbox"/> MOVED
<input type="checkbox"/> FAIR	<input type="checkbox"/> UNEXPOSED		DATE <u>Nov. 3</u> , '80

DESCRIBE THE PRESENT AND ORIGINAL (IF KNOWN) PHYSICAL APPEARANCE

Style - raised cottage

Number of stories - one and a half stories over partially sunken ground floor.

Foundation - brick

Basement - partially sunken ground floor.

Roof type - hipped

Roof covering - asbestos shingle

Roof trim - "blocky" Greek entablature/architrave

Porches- 46' - 8" (five bay front) X 44' - 0" including 12' deep porch. Hipped roof extended over raised full length piazza and supported by four octagonal colonnettes. Originally the porch was balustraded and latticed beneath. (removed c. 1945)

Doors - The central double-leaf entrance is excessively wide, making the single pane sidelights seem narrow. Nine pane transom. Sunken ground floor entrance: single-leaf doorway, double pane sidelights, no transom.

Windows- raised level: front side; four, six over six pane windows. sides; three, six over six pane windows with heart pine lintels.

sunken ground level: front side; two, four over four pane windows flanking central entrance. sides; three, four over four windows with heart pine lintels.

Chimneys- two exterior end chimneys - one exterior rear chimney.

Later additions- c. 1930 -dormers on lateral slopes of hipped roof and addition of frame rear wing.

The large shed -dormer at front was added in 1939.

\* Interior- Raised level; central hall plan. Two large rooms on left and one on right. Simple Greek revival style woodwork with faux bois finish remaining in places. see statement of significance.

According to Miss Clementine Lambretch (1972) the small interior wall staircase was sealed when the upstairs ceased to be used in the late 1940's.

\* This surveyor has been unable to obtain entrance in the Kaster House. All observations of the interior have been made by view through the windows.

## 8 SIGNIFICANCE

PERIOD	AREAS OF SIGNIFICANCE -- CHECK AND JUSTIFY BELOW			
<input type="checkbox"/> PREHISTORIC	<input type="checkbox"/> ARCHEOLOGY-PREHISTORIC	<input type="checkbox"/> COMMUNITY PLANNING	<input type="checkbox"/> LANDSCAPE ARCHITECTURE	<input type="checkbox"/> RELIGION
<input type="checkbox"/> 1400-1499	<input type="checkbox"/> ARCHEOLOGY-HISTORIC	<input type="checkbox"/> CONSERVATION	<input type="checkbox"/> LAW	<input type="checkbox"/> SCIENCE
<input type="checkbox"/> 1500-1599	<input type="checkbox"/> AGRICULTURE	<input type="checkbox"/> ECONOMICS	<input type="checkbox"/> LITERATURE	<input type="checkbox"/> SCULPTURE
<input type="checkbox"/> 1600-1699	<input checked="" type="checkbox"/> ARCHITECTURE	<input type="checkbox"/> EDUCATION	<input type="checkbox"/> MILITARY	<input type="checkbox"/> SOCIAL/HUMANITARIAN
<input type="checkbox"/> 1700-1799	<input type="checkbox"/> ART	<input type="checkbox"/> ENGINEERING	<input type="checkbox"/> MUSIC	<input type="checkbox"/> THEATER
<input checked="" type="checkbox"/> 1800-1899	<input checked="" type="checkbox"/> COMMERCE	<input type="checkbox"/> EXPLORATION/SETTLEMENT	<input type="checkbox"/> PHILOSOPHY	<input type="checkbox"/> TRANSPORTATION
<input type="checkbox"/> 1900-	<input type="checkbox"/> COMMUNICATIONS	<input type="checkbox"/> INDUSTRY	<input type="checkbox"/> POLITICS/GOVERNMENT	<input type="checkbox"/> OTHER (SPECIFY)
		<input type="checkbox"/> INVENTION		

---

SPECIFIC DATES            c. 1860

BUILDER/ARCHITECT

---

### STATEMENT OF SIGNIFICANCE

Although little is known about the brick and stucco raised cottage, it stands as a significant architectural creation in that it is one of only two brick residences built in Wilcox County prior to the War Between the States. (The other being the Bethea-Strother House at Canton Bend.) Built by Henry Kaster, a wealthy merchant born in Verden, Hanover (Germany), the house was begun on the eve of the War.

Kaster (1818-1878) owned a large mercantile establishment in the first floor of the Law Building (1848) another brick building in ante-bellum Camden. (The Law Building houses Albritton Drugs. Nov. 1980.)

According to the late Miss Clementine Lambretch, great niece of Kaster, the house was never really finished because the ships bringing the imported hardware and other features could not make it through the Union blockade around Mobile during the War.

The Kaster House was listed on the Historic American Buildings Survey in 1937.

---

Wall Material-            The exterior wall covering is brick coered with stucco. At the time of the (HABS) survey in 1937 the walls were scored to simulate ashlar.



## 9 MAJOR BIBLIOGRAPHICAL REFERENCES

Interview, Miss Clementine Lambretch, Camden, Alabama,  
March 13, 1972. (Miss Lambretch died in 1980.)

Interview, Robert Gamble, Birmingham, Alabama August 18, 1979

Historic American Buildings Survey, Library of Congress, Washington, D.C.

## 10 GEOGRAPHICAL DATA

ACREAGE OF NOMINATED PROPERTY 0.858

see map enclosure:

QUADRANGLE NAME Camden South Quadrangle

QUADRANGLE SCALE \_\_\_\_\_

UTM REFERENCES Alabama - Wilcox County

A			B		
ZONE	EASTING	NORTHING	ZONE	EASTING	NORTHING
C	16	47,204.0	35	3994.0	
E			F		
G			H		

### VERBAL BOUNDARY DESCRIPTION

Township 12, Range 7, section 29, NE quarter.  
NE corner of Broad and Hill Streets, Camden.

### LIST ALL STATES AND COUNTIES FOR PROPERTIES OVERLAPPING STATE OR COUNTY BOUNDARIES

STATE	CODE	COUNTY	CODE
STATE	CODE	COUNTY	CODE

## 11 FORM PREPARED BY

NAME / TITLE

Daniel F. Brooks, President

ORGANIZATION

Wilcox Historical Society

DATE

November 3, 1980

STREET & NUMBER

401 Mayo Street

TELEPHONE 682- 4899

682- 4234

CITY OR TOWN

Camden

STATE

Alabama

## 12 FOR ALABAMA HISTORICAL COMMISSION USE ONLY

Staff Member \_\_\_\_\_

ADDED \_\_\_\_\_ Number \_\_\_\_\_

Thematic Category \_\_\_\_\_

National Register Potential \_\_\_\_\_

Added to National Register \_\_\_\_\_

CAMDEN SOUTH QUADRANGLE

ALABAMA—WILCOX CO.

7.5 MINUTE SERIES (TOPOGRAPHIC)

3548 II  
(CARLOW V)  
1:62,500

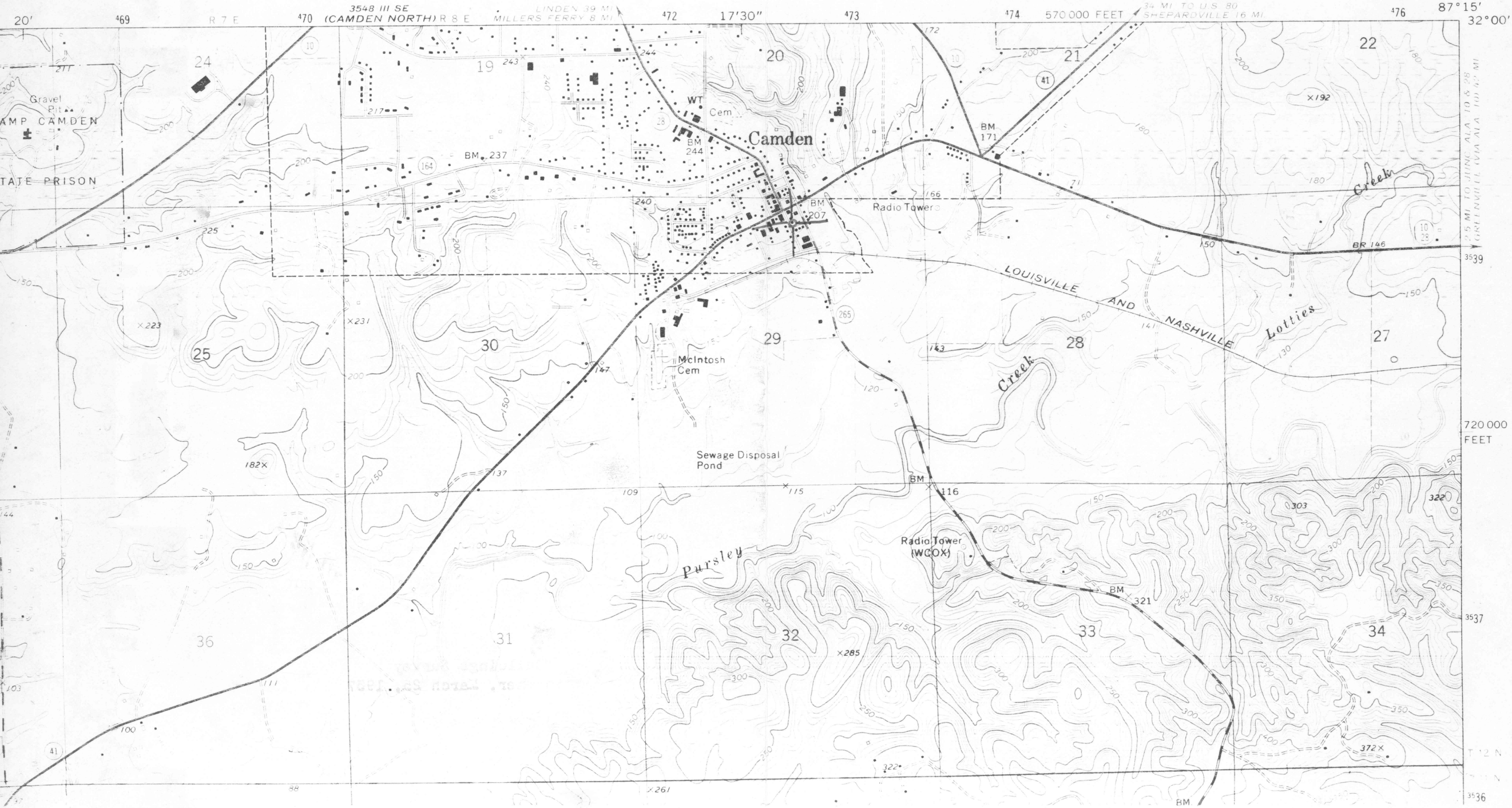

2.5 MI TO JUNG ALA 10 & 28  
GREENVILLE (VIA ALA 10) 4.5 MI

720 000  
FEET

T 12 N  
3536















