



STATE OF ALABAMA

ALABAMA HISTORICAL COMMISSION
725 MONROE STREET
MONTGOMERY, ALABAMA 36104
PHONE: 832-6621



ALABAMA REGISTER OF LANDMARKS AND HERITAGE NOMINATION FORM

COUNTY Cleburne

PRESENT NAME Arbacoochee HISTORIC NAME _____

LOCATION (Street and number) _____

TOWN (Give directions if rural) Arbacoochee

PRESENT USE Vacant HISTORIC USE Mining, Commerce

OWNERSHIP: Public () Private (X) Public acquisition being considered ()

OWNER'S NAME Miss Mary Neal

MAILING ADDRESS P. O. Box 849

DeArmanville, AL

CONDITION: Excellent () Good () Fair () Ruins (X)

INTEGRITY: Original site (X) Moved () When? _____

From where? _____ Give details in significance

THREATS: No () Yes (X) By what? Neglect

RESTORATION WORK: Being considered () Underway () Completed () Not planned (X)

SURROUNDING ENVIRONMENT: Open land () Woodland (X) Scattered buildings ()

Highway building density () Commercial () Industrial ()

Residential () Rural (X)

If there are numerous buildings in the area, could this structure be part of a Historic District?

SIGNIFICANCE: Why is this important (X) associated with events, persons, or movements
Local (X) State () National ()
() a good example of a type or style of structure
() other _____

Explain: Scene of gold rush before the California Gold Rush in 1849.

ARBACOOCHEE

SIGNIFICANCE

The town of Arbacoochee was a boom town in the days between 1836 and the California gold rush of 1849. At that time, it was the largest town in east Alabama with an estimated population of between 5,000 and 7,000. A hotel, drugstores, two saloons, churches, and other businesses gave the appearance of prosperity. Citizens lived in small frame houses or in tents. When the gold rush began in California, Arbacoochee was quickly abandoned and never regained its former glory.

There is only one building remaining at the present time and is in bad condition. It is a two-story brick building with a gabled tin roof. It was built as a general merchandise store, the proprietor lived on the second floor. The walls are 3 layers of brick thick. Although the structure has been burned out twice, the exterior has remained virtually unchanged since 1849.

Many of the holes and tunnels used by the miners are still evident along the road. Deep in the woods near the building is the "Glory Hole," the largest crevice in the area. Gold mining continued in spurts until the early 20th century. Tourists still come occasionally hoping to strike it rich. According to local citizens, the largest piece of gold found east of the Mississippi was found at Arbacoochee.

**NATIONAL REGISTER OF HISTORIC PLACES
INVENTORY - NOMINATION FORM**

(Type all entries - complete applicable sections)

STATE: Alabama	
COUNTY: Cleburne	
FOR NPS USE ONLY	
ENTRY NUMBER	DATE

1. NAME	
COMMON: Arbacoochee	
AND/OR HISTORIC: Same	

2. LOCATION			
STREET AND NUMBER:			
CITY OR TOWN: Arbacoochee			
STATE Alabama	CODE	COUNTY: Cleburne	CODE

3. CLASSIFICATION			
CATEGORY (Check One)	OWNERSHIP		STATUS
<input checked="" type="checkbox"/> District <input type="checkbox"/> Site <input type="checkbox"/> Building <input type="checkbox"/> Structure <input type="checkbox"/> Object	<input type="checkbox"/> Public <input checked="" type="checkbox"/> Private <input type="checkbox"/> Both	Public Acquisition: <input type="checkbox"/> In Process <input type="checkbox"/> Being Considered	<input checked="" type="checkbox"/> Occupied <input type="checkbox"/> Unoccupied <input type="checkbox"/> Preservation work in progress Yes: <input type="checkbox"/> Restricted <input type="checkbox"/> Unrestricted <input checked="" type="checkbox"/> No
PRESENT USE (Check One or More as Appropriate)			
<input type="checkbox"/> Agricultural <input type="checkbox"/> Commercial <input type="checkbox"/> Educational <input type="checkbox"/> Entertainment	<input type="checkbox"/> Government <input type="checkbox"/> Industrial <input type="checkbox"/> Military <input type="checkbox"/> Museum	<input type="checkbox"/> Park <input type="checkbox"/> Private Residence <input type="checkbox"/> Religious <input type="checkbox"/> Scientific	<input type="checkbox"/> Transportation <input checked="" type="checkbox"/> Other (Specify) <u>not presently in use</u>

4. OWNER OF PROPERTY	
OWNER'S NAME: Miss Mary Neal	
STREET AND NUMBER: P.O. Box 849	
CITY OR TOWN: DeArmanville	STATE: Alabama

5. LOCATION OF LEGAL DESCRIPTION	
COURTHOUSE, REGISTRY OF DEEDS, ETC: Cleburne County Courthouse	
STREET AND NUMBER:	
CITY OR TOWN: Heflin	STATE: Alabama

6. REPRESENTATION IN EXISTING SURVEYS	
TITLE OF SURVEY: not mentioned in any existing survey	
DATE OF SURVEY: <input type="checkbox"/> Federal <input type="checkbox"/> State <input type="checkbox"/> County <input type="checkbox"/> Local	
DEPOSITORY FOR SURVEY RECORDS:	
STREET AND NUMBER:	
CITY OR TOWN:	STATE:

STATE: Alabama
COUNTY: Cleburne
ENTRY NUMBER
DATE

FOR NPS USE ONLY

SEE INSTRUCTIONS

7. DESCRIPTION

CONDITION

(Check One)
☐ Excellent ☐ Good ☐ Fair ☒ Deteriorated ☐ Ruins ☐ Unexposed
 (Check One) (Check One)
☐ Altered ☒ Unaltered ☐ Moved ☒ Original Site

DESCRIBE THE PRESENT AND ORIGINAL (if known) PHYSICAL APPEARANCE

Present: There is only one building remaining at the present time and it is in bad condition. It is a two-story brick building with a gabled tin roof. The brick foundation of the building has deteriorated. Entrance to the building is constructed on two levels, and the steps leading to the second level are hazards. A large wooden door serves as a front entrance. Inspection of the inside of the building was impossible.

Original: The town of Arbacoochee was a boom town in the days preceding the California gold rush of 1849. At that time, it was the largest town in East Alabama with an estimated population of between 5-7000. Hotels, drug stores, saloons, churches and businesses gave the appearance of prosperity. Citizens lived in small frame houses or in tents. However, when the gold rush began out in California, Arbacoochee was quickly abandoned and, as is the way with ghost towns, it has never regained its former glory.

There are visible signs in the earth of the holes and tunnels built by the gold miners, and occasionally a small bit of gold is still found. It has been said that the largest piece of gold found east of the Mississippi was found at Arbacoochee.

SEE INSTRUCTIONS

8. SIGNIFICANCE

PERIOD (Check One or More as Appropriate)

☐ Pre-Columbian

☐ 16th Century

☐ 18th Century

☒ 20th Century

☐ 15th Century

☐ 17th Century

☒ 19th Century

SPECIFIC DATE(S) (If Applicable and Known)

abandoned 1849

AREAS OF SIGNIFICANCE (Check One or More as Appropriate)

Aboriginal

☐ Education

☐ Political

☐ Urban Planning

☐ Prehistoric

☐ Engineering

☐ Religion/Phi-

☐ Other (Specify)

☐ Historic

☒ Industry

☐ Philosophy

☐ Agriculture

☐ Invention

☐ Science

☐ Architecture

☐ Landscape

☐ Sculpture

☐ Art

Architecture

☐ Social/Human-

☐ Commerce

☐ Literature

itarian

☐ Communications

☐ Military

☐ Theater

☐ Conservation

☐ Music

☐ Transportation

STATEMENT OF SIGNIFICANCE

The town of Arbacoochee was a major town in East Alabama during the days preceding the California gold rush. With a population estimated at between 5-7000, Arbacoochee was the largest town in this area.

Much of the remaining buildings were burned in Coxton's Raid during the Civil War. As a result only one of the original buildings is still standing and it has deteriorated over the years.

Many of the holes and tunnels used by the miners are still evident along the road. Deep in the woods near the building is the "Glory Hole", a crevice some 15 feet deep, which was dug out by hand shovel by the miners. Originally the "Glory Hole" was much deeper but the natural erosion has filled it over the years. Gold mining continued in spurts until the early 20th century. Tourists still come occasionally hoping to strike it rich.

SEE INSTRUCTIONS

9. MAJOR BIBLIOGRAPHICAL REFERENCES

Interview with Joel Thompson, Cleburne County Agent, December 19, 1973.

Birmingham News, December 9, 1973.

Interview with Miss Mary Neal, February, 1974.

10. GEOGRAPHICAL DATA

LATITUDE AND LONGITUDE COORDINATES DEFINING A RECTANGLE LOCATING THE PROPERTY			O R	LATITUDE AND LONGITUDE COORDINATES DEFINING THE CENTER POINT OF A PROPERTY OF LESS THAN TEN ACRES		
CORNER	LATITUDE	LONGITUDE		LATITUDE	LONGITUDE	
	Degrees Minutes Seconds	Degrees Minutes Seconds		Degrees Minutes Seconds	Degrees Minutes Seconds	Degrees Minutes Seconds
NW	0 0 0	0 0 0		33° 34' 31"	85° 31' 04"	
NE	0 0 0	0 0 0				
SE	0 0 0	0 0 0				
SW	0 0 0	0 0 0				

APPROXIMATE ACREAGE OF NOMINATED PROPERTY: 1 acre

LIST ALL STATES AND COUNTIES FOR PROPERTIES OVERLAPPING STATE OR COUNTY BOUNDARIES: None

STATE:	CODE	COUNTY	CODE
STATE:	CODE	COUNTY:	CODE
STATE:	CODE	COUNTY:	CODE
STATE:	CODE	COUNTY:	CODE

11. FORM PREPARED BY

NAME AND TITLE:

Ellen Austin, Development Associate

ORGANIZATION

East Alabama Commission

DATE

3-24-74

STREET AND NUMBER:

200 Quintard Avenue, P.O. Box 2186

CITY OR TOWN:

Anniston

STATE

Alabama

CODE

12. STATE LIAISON OFFICER CERTIFICATION

NATIONAL REGISTER VERIFICATION

As the designated State Liaison Officer for the National Historic Preservation Act of 1966 (Public Law 89-665), I hereby nominate this property for inclusion in the National Register and certify that it has been evaluated according to the criteria and procedures set forth by the National Park Service. The recommended level of significance of this nomination is:

National ☐ State ☐ Local ☐

Name _____

Title _____

Date _____

I hereby certify that this property is included in the National Register.

Chief, Office of Archeology and Historic Preservation

Date _____

ATTEST:

Keeper of The National Register

Date _____

SEE INSTRUCTIONS

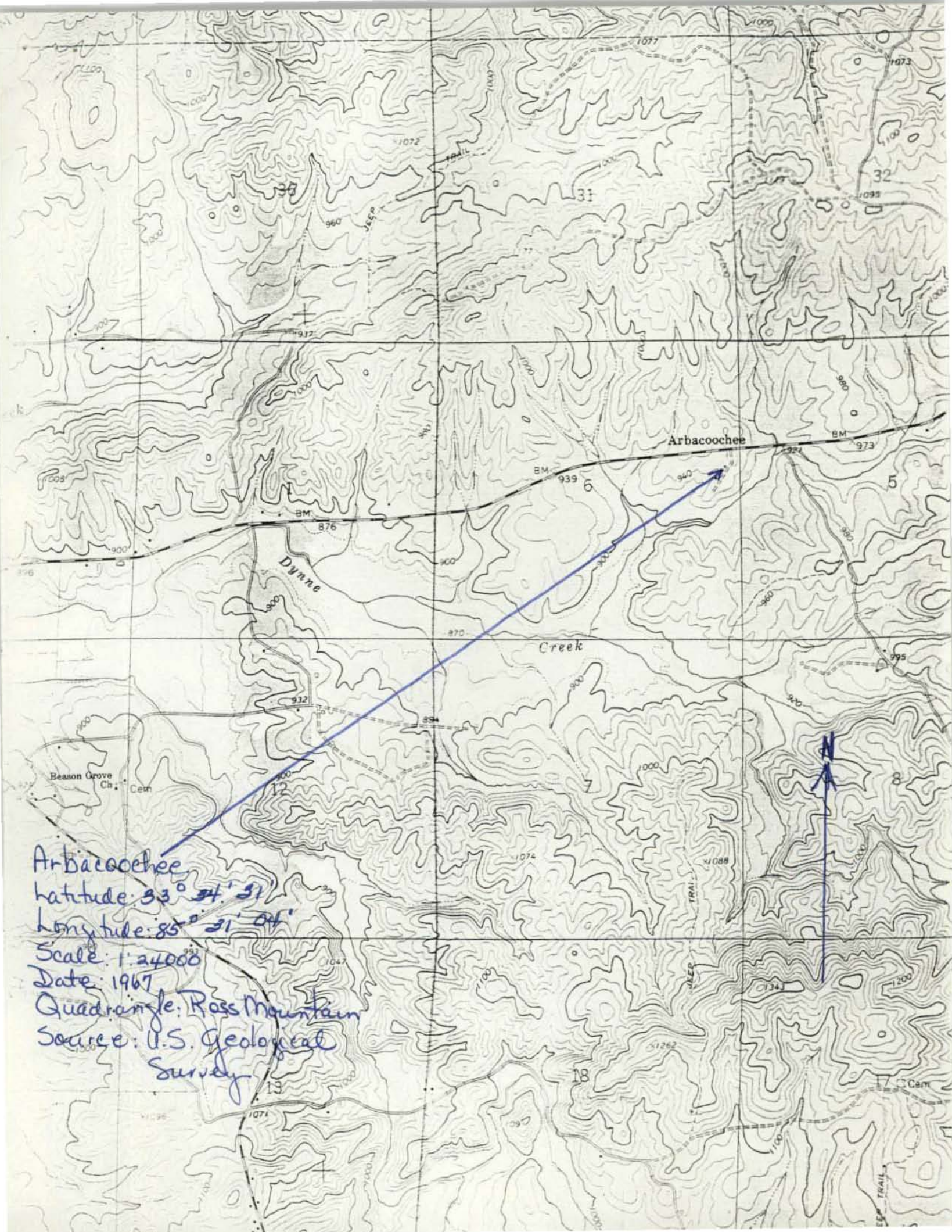

Arbacoochee

Latitude: $33^{\circ} 34' 31''$

Longitude: $85^{\circ} 31' 04''$

Scale: 1:24000

Date: 1967

Quadrangle: Ross Mountain

Source: U.S. Geological Survey

